



Ship Information

DOUGLAS MAWSON

We're excited to announce that the *Douglas Mawson* is joining our family of pioneering small ships in 2025.

Named after the legendary Australian geologist and explorer, our new ship embodies Mawson's pioneering spirit and is purpose-built for global discovery and off ship adventures.

Featuring the latest and greatest Ulstein X-BOW® and designed with sustainable features, it takes a maximum 154 adventurers to the world's wildest places in smooth, quiet comfort.

The ideal basecamp for adventure, our new ship features two restaurants, a gym and sauna, a heated outdoor pool and pool bar, jacuzzis, Citizen Science Centre, observation areas everywhere, and more types of staterooms than ever before, including single staterooms!

Ship Features

- Highly qualified and experienced expedition team and international crew.
- The *Douglas Mawson* is at the cutting edge of nautical technology: robust and powerful - the ultimate base camp for off-ship adventures.
- The latest Ulstein X-BOW® hull allows the ship to pierce through waves to maintain speed of travel thus offering faster, more comfortable travel, lower fuel consumption and reduced emissions.
- All staterooms feature twin or king bedding, with single staterooms featuring single bed configuration and private bathrooms. 79% of staterooms include a private balcony. Over 58 interconnecting Balcony Staterooms. Two staterooms can accommodate a third person (triple and single share on request).
- Observation lounge and viewing platforms offer spectacular panoramic views of scenery and wildlife.
- Purpose-built activity preparation areas including two Zodiac embarkation areas for fast and safe transition off the ship as you embark on multiple daily excursions.
- State-of-the-art lecture theatre, Citizen Science Centre and library. In between landings, enjoy our jacuzzis and pool or experience our gym & sauna.
- With huge windows and superb views to the front of the ship, the library or the atrium lounge is the perfect place to sit with a drink and watch for wildlife or admire impressive scenery.
- Starlink Wi-Fi - Free

Ship Specifications

Ulstein X-Bow® hull, safe return to port technology, dynamic positioning, and Zero Speed™ Stabilizers.

Capacity:	Maximum 154 passengers
Expedition team :	13 to 23 [^]
Hotel team:	47 to 56 [^]
Deck & Engine Crew:	24
Staterooms:	86
Decks:	8
Year built:	2025
Chart Class:	A1 Ice Class
Length:	104.4m
Breadth:	18.4m
Draught:	5.1m
Average Speed:	10-12 Knots
Full Speed:	15.5 Knots – maximum speed only used in case of emergencies
Tonnage:	GT 8500
Registry:	Madeira, Portugal
Voltage:	220V, 60HZ AC. Universal plug

[^] Dependent on passenger numbers.

Staterooms & Suites



Aurora Stateroom Single

Stateroom 9.85m², porthole and bathroom.



Aurora Stateroom Superior Single

Deck 3 Stateroom 15.18m², Porthole and bathroom. Deck 7 Stateroom 10.97m², French balcony and bathroom.



Aurora Stateroom Triple

Stateroom 22.57m², porthole and bathroom.



Aurora Stateroom Twin

Stateroom 15.37m²–15.97m², window and bathroom.



Aurora Stateroom Superior

Stateroom up to 13.97m² – 16.17m², French balcony and bathroom.

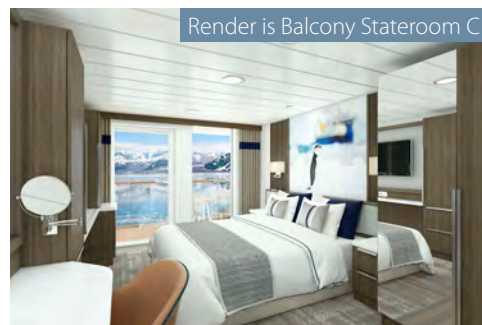

Balcony Stateroom

Stateroom and private balcony combined size 21.07m² – 26.77m², balcony and bathroom.

For stateroom sizes in categories A, B and C please contact us.

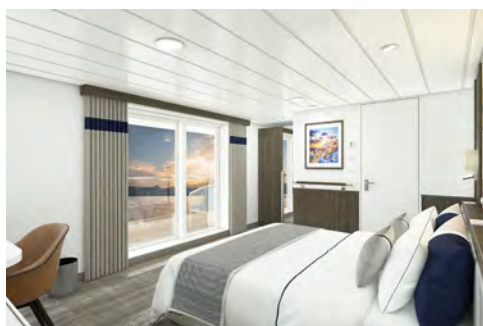

Balcony Stateroom Superior

Stateroom and private balcony combined size 27.77m² – 36.27m², balcony and bathroom.



Junior Suite

Stateroom and private balcony combined size up to 41.47m²– 41.87m², balcony, bathroom and lounge.



Captain's Suite

Stateroom and private balcony combined size 45.22m², balcony, bathroom and lounge.











*Layouts are a guide only, the stateroom configuration may vary dependent on the location of the stateroom on the ship.

Deck Plan

Ship Features

- ① Change room/mudroom
- ② Zodiac access points
- ③ Activity launching platform
- ④ Lecture room & lounge
- ⑤ Assembly station
- ⑥ Reception
- ⑦ Ship shop
- ⑧ Dining room
- ⑨ Library
- ⑩ Gym
- ⑪ Sauna
- ⑫ Seating area
- ⑬ Observation lounge
- ⑭ Top-deck restaurant
- ⑮ Bar
- ⑯ Upper glass atrium lounge
- ⑰ Lower glass atrium lounge
- ⑱ Observation decks
- ⑲ Swimming pool* and sun deck
- ⑳ Jacuzzis
- ㉑ Medical clinic
- ㉒ Bridge
- ㉓ Elevator
- ㉔ Main entrance
- ㉕ Expedition desk
- ㉖ Citizen Science centre
- ♿ Disability accessible staterooms

Stateroom Category

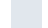
- | | | | |
|---|----------------------------------|---|----------------------------|
|  | Aurora Stateroom Single |  | Balcony Stateroom – B |
|  | Aurora Stateroom Superior Single |  | Balcony Stateroom – A |
|  | Aurora Stateroom Twin |  | Balcony Stateroom Superior |
|  | Aurora Stateroom Triple |  | Junior Suite |
|  | Aurora Stateroom Superior |  | Captain's Suite |
|  | Balcony Stateroom – C | | |

Deck 8

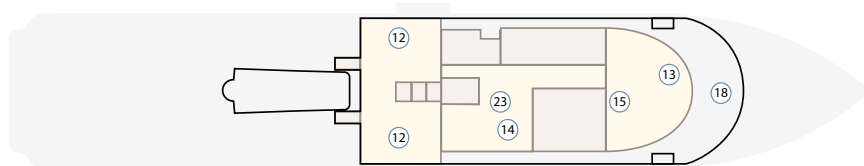

Deck 7

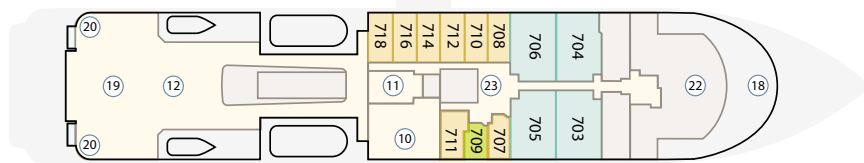

Deck 6

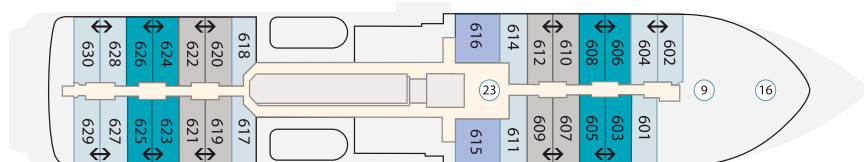

Deck 5

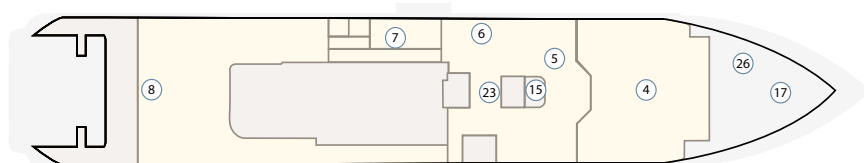

Deck 4

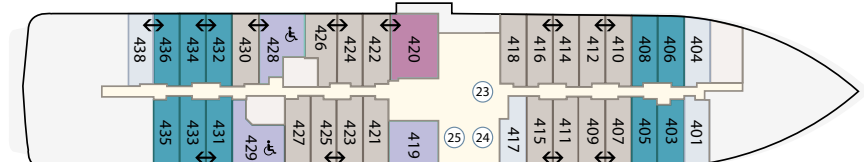

Deck 3

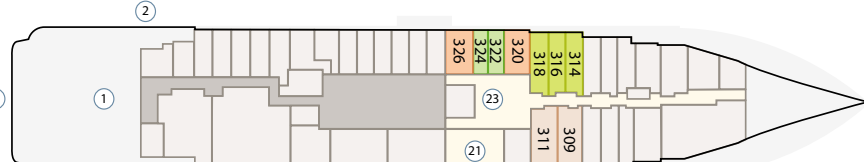

↔ Connecting staterooms and suites

*Swimming pool not operational when sailing in open waters. Hours of operation subject to weather conditions.

Deck plan is subject to change.